



Obstacles to Development

7th Annual Sociology of Development Conference

October 19-21, 2018

UNIVERSITY OF ILLINOIS AT URBANA-CHAMPAIGN
URBANA, ILLINOIS

I ILLINOIS
Sociology
COLLEGE OF LIBERAL ARTS & SCIENCES

Welcome

On behalf of the Department of Sociology, I would like to welcome you to the University of Illinois at Urbana-Champaign and the Seventh Annual Sociology of Development conference. We are truly delighted that you have chosen to join us for this conference, an important aim of which is to identify and explore some of the many obstacles to development present in the world today. We are looking forward to many thought-provoking presentations and engaging conversations on numerous topics related to development. October is a usually a lovely time of the year in this Midwest college town, and we very much hope that you will enjoy your visit.

Brian Dill
Interim Head

About the University of Illinois

Since its founding in 1867, the University of Illinois at Urbana-Champaign has earned a reputation as a world-class leader in research, teaching, and public engagement. With our land-grant heritage as a foundation, we pioneer innovative research that tackles global problems and expands the human experience. Our transformative learning experiences, in and out of the classroom, are designed to produce alumni who desire to make a significant, societal impact.

About Urbana-Champaign

Located within only a couple hours of three major metropolitan cities (Chicago, Indianapolis, and St. Louis) Urbana-Champaign is an outstanding micro-urban community. With more than 1,000 acres of city parks, we have been named one of the greenest cities in the U.S. Although Urbana-Champaign is often hailed as the home of the University of Illinois, the twin cities have much more to offer. For ideas about things to see and do while you are here in our community please see the links below. Enjoy!

- Champaign-Urbana: smart. innovative. micro-urban. (YouTube video)
www.youtube.com/watch?v=Kz1iDpiVPpw&feature=youtu.be
- ExploreCU is a free web and mobile platform about the arts, culture, and history of Champaign-Urbana and its surrounding area.
www.exploreku.org
- Visit Champaign County is the official tourism destination marketing and management organization for Champaign County.
www.visitchampaigncounty.org

Sponsor

Department of Sociology at the University of Illinois at Urbana-Champaign
sociology.illinois.edu

Supporters

We are truly grateful for the generous support from the following:

- Center for East Asian and Pacific Studies,
University of Illinois at Urbana-Champaign
www.eaps.illinois.edu
- Center for Latin American and Caribbean Studies,
University of Illinois at Urbana-Champaign
www.clacs.illinois.edu
- Center for South Asian and Middle Eastern Studies,
University of Illinois at Urbana-Champaign
www.csames.illinois.edu
- College of Liberal Arts and Sciences,
University of Illinois at Urbana-Champaign
www.las.illinois.edu
- Kellogg Institute for International Studies,
University of Notre Dame
kellogg.nd.edu
- Office of International Programs, College of ACES,
University of Illinois at Urbana-Champaign
intlprograms.aces.illinois.edu/about/our-staff
- Russian, East European, and Eurasian Center,
University of Illinois at Urbana-Champaign
reeec.illinois.edu
- Women and Gender in Global Perspectives Program,
University of Illinois at Urbana-Champaign
wgpp.illinois.edu

Acknowledgements

Many thanks to the following for their invaluable assistance:

Scott Randolph, Conference and Event Planning Services,
Center for Innovation in Teaching and Learning, University
of Illinois at Urbana-Champaign

Brad Petersen, Director of Communications and Marketing,
College of Liberal Arts & Sciences, University of Illinois at
Urbana-Champaign

Shari Day, Department of Sociology, University of Illinois
at Urbana-Champaign Graduate Students, Department of
Sociology, University of Illinois at Urbana-Champaign

Graduate Students, Department of Sociology,
University of Illinois at Urbana-Champaign

Dining

We will provide you with breakfast, lunch, and plenty of coffee during at the conference. In the evening, you will have the opportunity to explore some of the fabulous dining options that Champaign and Urbana have to offer.

For a complete guide to the food and drink options, please visit this link:

www.visitchampaigncounty.org/business/category/54/food-and-drink//54

Here are a few of our favorites:

Big Grove Tavern (Champaign)

Offering the very best in fresh American Cuisine with a wide selection of seasonal house cocktails, Midwestern craft beers and carefully curated wines. Private dining available.

www.biggrovetavern.com

Black Dog Smoke and Ale house (Champaign and Urbana)

Black Dog Smoke and Ale House, with their custom-made smoker, cooks some of the finest barbecue in town. Rated #2 on Maxim's best barbecue in the country, you'll find a location in both Urbana and Champaign. Daily specials include selections like smoked pork belly, bacon-wrapped meatloaf or fried catfish sandwich.

www.blackdogsmoke.com

Miga (Champaign)

Miga is an upscale restaurant serving modern American cuisine, sushi, wine and handcrafted cocktails. Suitable for every pallet, our elegant array of culinary specialties is sure to fulfill your desires.

miga-restaurant.com

V. Picasso (Champaign)

V.Picasso is a farm-to-table restaurant featuring vintages on tap, handcrafted cocktails and farm-focused cuisine made with local ingredients, grown and raised for us by Willow Creek Farm.

www.vpicasso.com

Watson's Shack and Rail (Champaign)

Watson's is a fine-casual chicken shack, bar, and restaurant. Our specialties included fried and rotisserie style chicken with our Nashville Hot Chicken and Fried Chicken and Waffles taking center stage on most nights. Our delicious chicken is supplemented with our house made biscuits, seasonal sides, and chef-driven appetizers and specials.

www.watsonschicken.com

University of Illinois: Campus Map

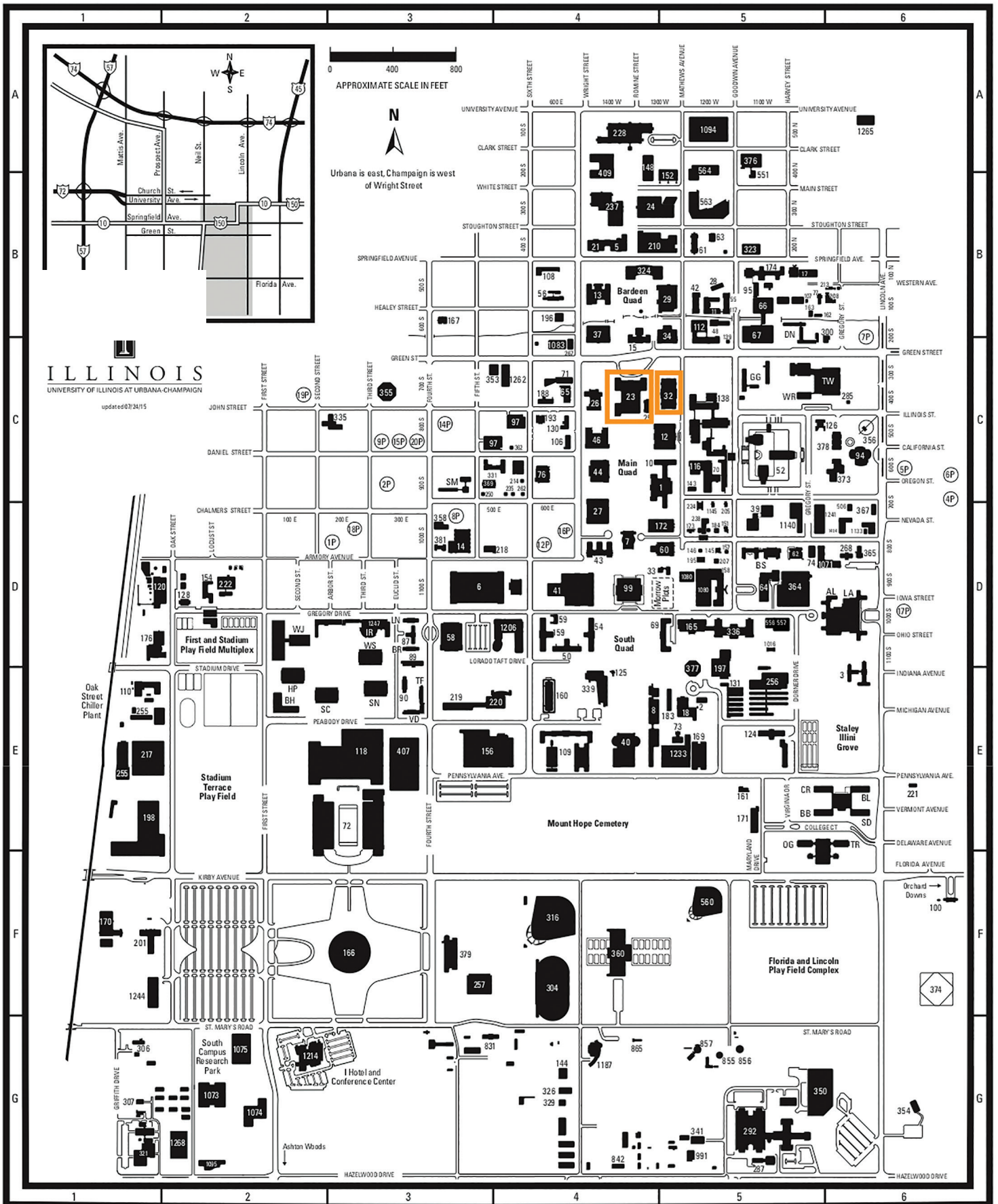

Campus Map

The designation in parentheses (D1) indicates the map coordinates.

Building Name (Map Coordinates)

A

120	Abbott Power Plant (D1)
377	ACES Library & Info Center (E5)
118	Activities and Recreation Cntr (E2)
378	Admissions and Records (C6)
17	Advanced Computation Bldg (B5)
1093	Aerodynamics Research Lab (B5)
28	Aeronautical Lab A (B5)
157	Afro-Amer Studies & Rsch Prog (D5)
73	Agricultural Bioprocess Lab (E5)
8	Ag Engineering Sci Bldg (E4)
326	Agriculture Services Bldg (G4)
329	Ag Services Warehouse (G4)
842	Agronomy Seed House (G4)
991	Agronomy Soybean Rsch Farm (G5)
94	Alice Campbell Alumni Center (C6)
26	Altgeld Hall (C4)
831	Animal Science Barns (G3)
165	Animal Sciences Lab (D5)
374	Arboretum—Hartley Gardens (F6)
18	Architecture Annex (E5)
50	Architecture Bldg (D4)
6	Armory (D3)
219	Art & Design Bldg (E3)
1145	Asian American House (C5)
568	Asian American Studies Bldg (D5)
300	Astronomy Bldg (B5)
1075	Atkins Bldg (G2)
360	Atkins Tennis Ctr (F4)
208	Atmospheric Sciences Bldg (B6)
139	Atmospheric Sciences Annex 2 (B5)

B

228	Beckman Institute (A4)
335	Beckwith Hall (C2)
158	Bevier Hall (D5)
379	Bieffeldt Athletic Admin Bldg (F3)
307	Biological Control Lab (G1)
169	Burnsides Rsch Lab (E5)
138	Burrill Hall (C5)
<i>Business Instructional Facility</i>	
—see C 1206	

C

<i>Campbell Alumni Center—see A 94</i>	
376	Campbell Hall for Public Telecommunications (A5)
364	Campus Recreation Ctr East (D5)
380	Campus Rec Outdoor Ctr (D2)
71	Career Center (C4)
285	Center for Advanced Study (C6)
1494	Center for Wounded Veterans in Higher Education (D6)
170	Central Receiving Bldg (F1)
55	Ceramics Bldg (B5)
11	Ceramics Kiln House (C5)
70	Chemical & Life Sci Lab (C5)
10	Chemistry Annex (C5)
62	Child Development Lab A (D5)
87	Clark Hall Housing Admin (D3)
130	Coble Hall (C4)
1206	College of Business Instructional Facility (D4)
167	Colonel Wolfe School (B3)
108	Computing Applications Bldg (B4)
148	Coordinated Science Lab (A4)

D

855-857	Dairy Exper Round Barns (G5)
365	Dance Admin Bldg (D6)
268	Dance Studio (D6)
1	Davenport Hall (C5)
54	David Kinley Hall (D4)
1187	Demirjian Golf Practice Facility (G4)
210	Digital Computer Lab (B4)
1133	Doris Kelley Christopher Hall (D6)

E

1071	Early Child Development Lab (D5)
160	Education Bldg (E4)
560	Eichelberger Field (F5)
409	Electrical and Computer Engineering Bldg (A4)
15	Engineering Hall (B4)
162	Engineering Sr Design Studio (B6)
174	Engineering Sciences Bldg (B5)
1209	Engineering Student Project Lab (B5)

44	English Bldg (C4)
1095	Enterprise Works (G2)
213	Environmental Health & Safety (B6)
37	Everitt Lab (B4)

F

306	FAA Design Research Lab (G1)
2	FAA Performing Arts Annex (E5)
556-557	Fire Substation (D5)
89	Flagg Hall (E3)
7	Foellinger Auditorium (D4)
1073	Forbes Natural History Building (G2)
172	Foreign Languages Bldg (D4)
64	Freer Hall (D5)

G

201	Garage/Car Pool (F1)
128	Geological Survey Lab (D1)
74	Govt & Public Affairs, Inst of (D5)
324	Grainger Engr Library Info Ctr (B4)
43	Gregory Hall (D4)
1140	Gregory Place I (C5)
1241	Gregory Place II (School of Social Work) (D5)

H

4	Harding Band Bldg (D4)
25	Harker Hall (C4)
<i>Hartley Gardens—see A 374</i>	
356	Hallene Gateway (C6)
46	Henry Admin Bldg (C4)
217	Housing Food Stores (E1)
58	Huff Hall (D3)
152	Hydrosystems Lab (A5)

I

14	Ice Arena (D3)
1214	I Hotel & Conference Center (G2-3)
65	Illini Hall (C4)
23	Illini Union (C4)
106	Illini Union Bookstore (C4)
316	Illinois Field (F4)
369	International Studies Bldg (C3)
1080	Institute for Genomic Biology (D5)
1233	Integrated Bioprocessing Lab (E5)
381	Irwin Academic Services Ctr (D3)
407	Irwin Indoor Football Pract Fclty (E3)

J-K

354	Japan House (G6)
21	Kenney Gym (B4)
5	Kenney Gym Annex (B4)
220	Krannert Art Museum & Kinkead Pavillion (E3)
52	Krannert Ctr for Performing Arts (C5)

L

218	Labor & Employment Relations, School of (D3)
<i>Large Animal Clinic—see V 292</i>	
156	Law Bldg (E3)
126	Levis Faculty Ctr/Visitor Ctr (C5)
41	Library (D4)
331	Library & Information Science (C3)
27	Lincoln Hall (D4)
67	Loomis Lab (B5)

M

336	Madigan Lab (D5)
34	Materials Sci & Engr Bldg (B5)
3	McKinley Health Ctr (E6)
171	Meat Science Lab (E5)
112	Mechanical Engineering Bldg (B5)
29	Mechanical Engineering Lab (B5)
192	Medical Sciences Bldg (C5)
72	Memorial Stadium (E3)
237	Micro & Nanotechnology Lab (B4)
242	Morrill Hall (C5)
69	Mumford Hall (D4)
125	Mumford House (E4)
39	Music Bldg (D5)
506	Music Education Annex (D6)

N

124	National Soybean Rsch Ctr (E5)
568	Native American House (D5)
32	Natural History Bldg (C5)
109	Natural Resources Bldg (E4)
321	Natural Res Studies Annex (G1)
564	NCSA (A5)
1244	NCSA Petascale Computing Facility (F1)
24	Newmark Lab (B4)
90	Noble Hall (E3)

232	North Campus Chiller Plant (A5)
1094	North Campus Parking Deck (A5)
12	Noyes Lab (C5)
117	Nuclear Engineering Lab (B5)
110	Nuclear Physics Lab (E1)
48	Nuclear Radiations Lab (B5)
267	Nursing, School of (C4)

O

33	Observatory (D5)
196	Optical Physics & Engr Lab (B4)

P

97	Parking Structures (C3, A5)
556-557	Parking Structure/Fire Substation (D5)
154	Personnel Services Bldg (D2)
198	Physical Plant Service Bldg (E1)
<i>Plant & An Biotech Lab—see M 336</i>	
865	Plant Clinic (G4)
256	Plant Sciences Lab (E5)
77	Plant Services Bldg NE (B5)
163	Plant Services Storage Bldg (B5)
358	Police Training Institute (D3)
100	President's House (F6)
222	Printing Services Bldg (D2)
76	Psychology Bldg (C4)
323	Public Safety (B5)

R

176	Rehabilitation Education Ctr (D1)
<i>Research Park (G2)</i>	
<i>Richmond Studio (A5)</i>	
551	Robert A. Evers Laboratory (G2)
1268	Roger Adams Lab (C5)
116	

S

1241	School of Social Work (Gregory Place II) (D5)
66	Seitz Materials Research Lab (B5)
563	Siebel Ctr for Computer Sci (B5)
<i>Small Animal Clinic—see V5</i>	
60	Smith Hall (D4)
209	Speech & Hearing Clinic (C4)
373	Spurlock Museum (C6)
166	State Farm Center (F3)
40	Stock Pavilion (E4)
71	Student Services Arcade Bldg (C4)
1247	Student Dingling and Residential Programs Building (D3)
95	Superconductivity Ctr (B5)
59	Surveying Bldg (D4)
193	Swanlund Admin Bldg (C4)

T

161	Taft House (E5)
13	Talbot Lab (B4)
1083	Technology Place (C4)
339	Temple Hoyne Buell Hall (E4)
355	Tower on Third (C3)
304	Track & Soccer Stadium (F4)
42	Transportation Bldg (B5)
197	Turner Hall (E5)
131	Turner Hall Greenhouses (E5)
188	Turner Student Services Bldg (C4)

U

257	Ubber Basketball Facility (F3)
99	Undergraduate Library (D4)
61	University High School (B5)
63	University High School Gym (B5)
255	University Press Bldg (E1)

V

1016	Vegetable Crops Bldg (D5)
1265	Vermilion Development Building (A6)
350	Vet Med Basic Sciences Bldg (G5)
341	Vet Med Feed Storage Bldg (G5)
287	Vet Med Surgery & Obstetrics Lab (G5)
292	Vet Teaching Hospital (G5)
<i>Visitor's Center—see L 126</i>	
56	Vivarium, Shelford (B4)

W

183	Wood Engineering Lab (E5)
159	Wohlers Hall (D4)

Z

1074	Z Bldg (G2)
------	-------------

BUILDINGS BY ADDRESS

262	510 East Chalmers (C4)
235	512 East Chalmers Street (C4)
362	507 East Daniel Street (C4)
250	912 South Fifth Street (C3)
353	505 East Green Street (C4)
1262	507 East Green Street (C4)
143	608 South Mathews Avenue (C4)
173	708 South Mathews Avenue (D5)
367	901 W. Oregon (D6)
195	1203 West Nevada Street (D5)
207	1203 ½ West Nevada Street (D5)
151	1204 West Nevada Street (C4)
145	1205 West Nevada Street (C4)
146	1205 ½ West Nevada Street (C4)
184	1208 West Nevada Street (C4)
205	1203 West Oregon Street (D5)
224	1205 West Oregon Street (D5)
238	1207 West Oregon Street (D5)
221	805 West Pennsylvania (E6)
214	911 South Sixth Street (C4)

UNIVERSITY RESIDENCE HALLS

Undergraduate Halls

Champaign Residence Halls

BR	Barton (D3)
HP	Hopkins (E2)
IR	Ikenberry (D3)
LN	Lundgren (D3)
NU	Nugent (D3)
BH	Bousfield Hall (D2)
SC	Scott (E2)
SN	Snyder (E3)
TF	Taft (E3)
VD	Van Doren (E3)
WS	Weston (D3)
WJ	Wassaja Hall (D2)

Urbana North Residence Halls

AL	Allen (D6)
BS	Busey-Evans (D5)
LA	Lincoln Ave (Shelden-Leonard) (D6)
	Illinois Street
TW	Townsend (C6)
WR	Wardall (C5)

Urbana South Residence Halls

Pennsylvania Avenue

BB	Babcock (E6)
BL	Blaisdell (E6)
CR	Carr (E6)
SD	Saunders (E6)

Florida Avenue

OG	Oglesby (E6)
TR	Trelease (E6)

Graduate Halls

DN	Daniels (B5)
SM	Sherman (C3)

Family Housing

AW	Ashton Woods (south of G2)
GG	Goodwin/Green Apts (C5)
OD	Orchard Downs Apts (East of F6)

Private Certified Housing

1P	Armory House (D3)
2P	Bromley Hall (C3)
4P	Brown House on Coler (C6)
5P	Christian Campus House (C6)
6P	Europa House (C6)
7P	Hendrick House (B6)
8P	Illini Tower (D3)
9P	Koinonia (C3)
12P	Newman Hall (D4)
14P	Presby House (C3)
15P	Stratford House (C3)
16P	University YMCA (D4)
17P	Nabor House (D6)
18P	Evans Scholars (D3)
19P	NIKA House (C2)
20P	3:12 House (C3)

CONFERENCE PROGRAM

Friday, October 19

TIME	ACTIVITY	LOCATION
3-4:30 p.m.	Registration	North Lounge, Illini Union
4:30-5 p.m.	Introduction and Welcome	Room 2079 Natural History Bldg.
5-6 p.m.	Keynote	Room 2079 Natural History Bldg.
6-7 p.m.	Reception	South Lounge, Illini Union

Saturday, October 20

TIME	ACTIVITY	LOCATION
8-8:30 a.m.	Breakfast / Registration	Illini Room C
8:30-10 a.m.	Session 1	Illini Union
10-10:30 a.m.	Coffee Break	Illini Room C
10:30 a.m.-12 p.m.	Session 2	Illini Union
12-1:30 p.m.	Plenary and Lunch	Illini Room C
1:30-3 p.m.	Session 3	Illini Union
3-3:30 p.m.	Coffee Break	Illini Room C
3:30-5 p.m.	Session 4	Illini Union
5-6 p.m.	Plenary	Illini Room C
6-7 p.m.	Reception	South Lounge, Illini Union

Sunday, October 21

TIME	ACTIVITY	LOCATION
8-8:30 a.m.	Breakfast / Registration	Illini Room C
8:30-10 a.m.	Session 5	Illini Union
10-10:30 a.m.	Coffee Break	Illini Room C
10:30 a.m.-12 p.m.	Session 6	Illini Union
12-1:30 p.m.	Closing Plenary and Lunch	Illini Room C

Illini Union: Main Floor

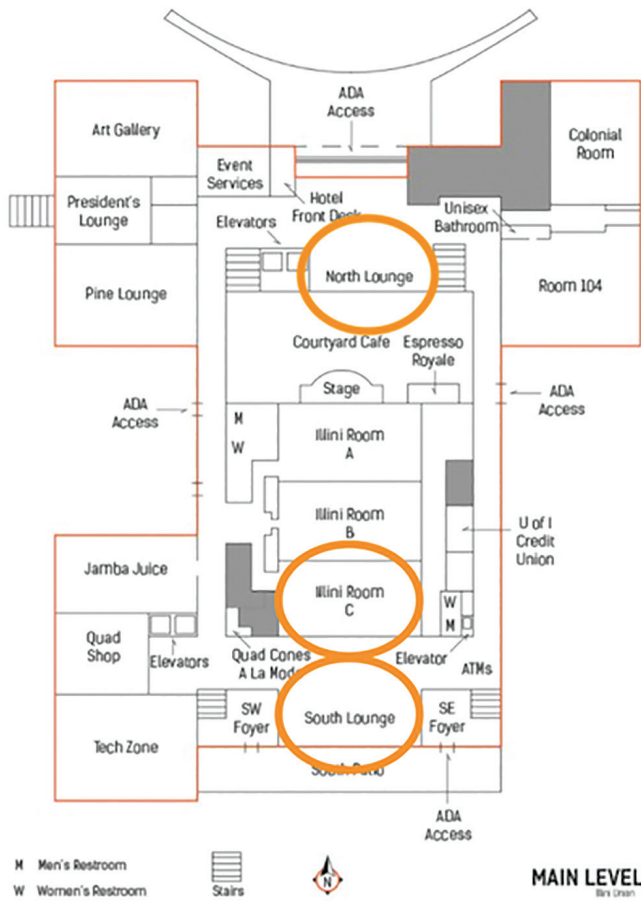

Illini Union: Session Rooms

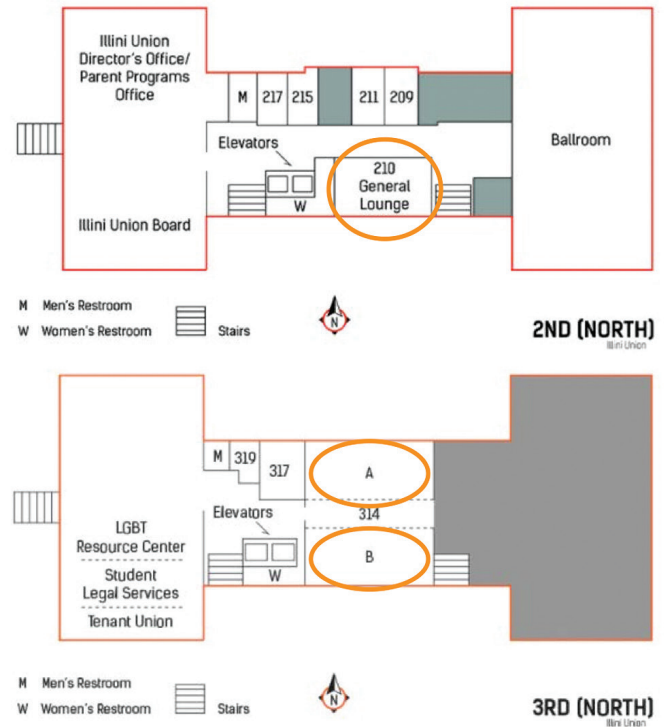

Natural History Building: Second Floor

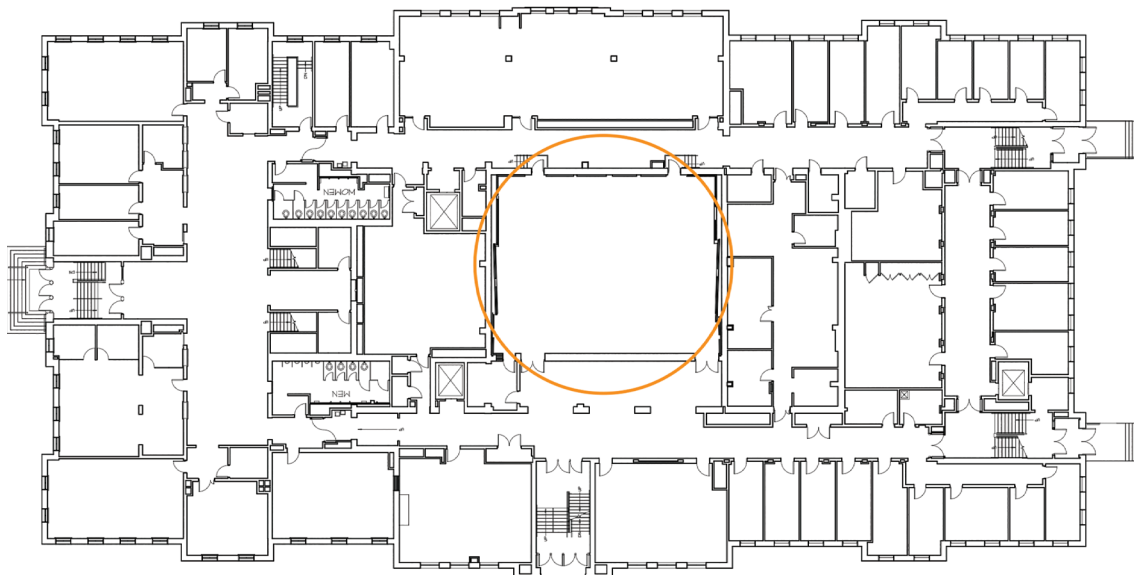

KEYNOTE SPEAKERS

Tami Bond

University of Illinois

Tami Bond is the Nathan M. Newmark Distinguished Professor in the Department of Civil and Environmental Engineering at the University of Illinois at Urbana-Champaign. Dr. Bond has worked in the field of household energy, especially ameliorating emissions of solid-fuel burning that affect householders and their neighbors. Her group has done field measurements in Nepal, China, India, Uganda, and Honduras, and they provide technical assistance to organizations in these countries to support ongoing evaluation capabilities for household energy. Bonds work promotes the view that each household is a physical system that provides services, and that these services are intricately connected with well-being and self-perception. Bond holds an interdisciplinary Ph.D. in Civil Engineering, Mechanical Engineering and Atmospheric Science from the University of Washington. She is a 2014 John D. and Catherine T. MacArthur Fellow and a Fellow of the American Geophysical Union. In 2018-19, she will hold a Leverhulme Visiting Professorship at the University of Leeds, UK, to explore the intersection of energy provision and climate vulnerability for low-income populations.

Laura Doering

University of Toronto

Laura Doering is Assistant Professor of Strategic Management at the University of Toronto. As an economic sociologist, her research examines how micro-level decisions, relationships, and circumstances affect economic outcomes in developing countries. Substantively, she focuses on entrepreneurship and financial access in low-income areas. Her research has been published in the *American Journal of Sociology*, *American Sociological Review*, and *Sociology of Development*. A former Fulbright Scholar, Professor Doering's research has been profiled in The New York Times and The Globe and Mail, and her writing has appeared in BBC News, CBS News, Salon, and other outlets.

Margaret Frye

University of Michigan

Margaret Frye is an Assistant Professor of Sociology at the University of Michigan. She studies how culture shapes demographic behavior, with a particular interest in education and sexual relationships. Empirically, her research has focused primarily on sub-Saharan Africa and has employed a variety of methodological strategies. She is currently engaged in data collection for a new project in Kampala, where she is examining changing understandings of status resulting from Uganda's simultaneous expansion of university education and contraction of employment opportunities.

J. Craig Jenkins

Ohio State University

J. Craig Jenkins is Professor Emeritus of Sociology at the Ohio State University. He directed the Merhson Center for International Security Studies from 2011 to 2015 and is now senior research scientist. Jenkins is author of more than 80 referred articles and book chapters, as well as author or editor of several books including *The Politics of Insurgency: The Farm Worker's Movement of the 1960s*; *The Politics of Social Protest: Comparative Perspectives on States and Social Movements*, with Bert Klandermans; *Identity Conflicts: Can Violence be Regulated?*, with Esther Gottlieb and *Handbook of Politics: State and Society in Global Perspective*, with Kevin T. Leicht. He has received numerous awards, including the Robin M. Williams Jr. Award for Distinguished Contributions to Scholarship, Teaching and Service from the Section on Peace, War and Social Conflict of the American Sociological Association (2015), fellow of the American Association for the Advancement of Science (2009), Joan Huber Faculty Fellow (2003), chair of the Section on Committees of the American Sociological Association (1998-2000), chair of the Section on Political Sociology, ASA (1995-96), and chair of the Section on Collective Behavior and Social Movements, ASA (1994-95). He was elected to the Sociological Research Association in 1993 and was a national security fellow at the Merhson Center for International Security at Ohio State in 1988, a Merhson Center professor from 2003-06 and chair of the Sociology

Department, 2006-2010. Jenkins has received numerous grants from funding agencies, including the National Science Foundation, National Endowment for Humanities and Russell Sage Foundation. In 2010-11, he received a Liev Eriksson Mobility Grant from the Norway Research Council. In 2011-12, Jenkins was a Fulbright Fellow to Norway and a visiting professor at the Peace Research Institute of Oslo (PRIO) in Oslo, Norway. In 2017, Jenkins and co-investigator Maciek Slomczynski received a \$1.4 million grant from the National Science Foundation for a four-year project on “Survey Data Recycling: New Analytic Framework, Integrated Database and Tools for Cross-National Social, Behavioral and Economic Research.”

Terrence McDonnell

University of Notre Dame

Terry McDonnell is Associate Professor of Sociology, Concurrent the Keough School of Global Affairs. He is a cultural sociologist who studies objects and media in everyday life. His recent book, *Best Laid Plans: Cultural Entropy and the Unraveling of AIDS Media Campaigns* (University of Chicago Press) explains why best practices and evidence-based HIV/AIDS media campaigns in Ghana often fail to change peoples’ belief and behavior. Developing the concept of “cultural entropy,” he finds that international health NGO’s find it difficult to control their messages. As modernization and globalization makes culture more complex, the chances for misinterpretation and misuse of AIDS campaigns increase. *Best Laid Plans* won the Eliot Freidson Outstanding Publication Award from the Medical Sociology section of the ASA, and won honorable mentions for best book from the Sociology of Development Section, and the Communication, Information Technologies, and Media Sociology Section. His research has been published in numerous sociological journals including *The American Journal of Sociology*, *Sociological Theory*, *Social Problems*, *Poetics*, *Qualitative Sociology*, and *Theory and Society*. His broad interests include health and AIDS, social movements, development, gender and sexuality, urban studies, theory, and qualitative methods.

Paul McNamara

University of Illinois

Paul E. McNamara is an Associate Professor in the Department of Agricultural and Consumer Economics and the Division of Nutritional Sciences at the University of Illinois at Urbana-Champaign, and he is a Visiting Member of the faculty of Njala University (Sierra Leone). Dr. McNamara directs AgReach (www.agreach.illinois.edu), a program at the University of Illinois for strengthening agricultural and nutrition extension services and implementing development activities around the world with a goal of increasing smallholder economic and food security. He serves as Principal Investigator for the USAID-funded INGENAES project and the Feed the Future Strengthening Agriculture and Nutrition Extension project in Malawi. Dr. McNamara holds a Ph.D. from the Department of Applied Economics at the University of Minnesota and an M.P.P. from the Harvard Kennedy School. Since a seven-month field internship in South Cotabato Province in the Philippines in 1982, Dr. McNamara has been involved in international development activities. He has worked in The Gambia, the Philippines, India, Uganda, Sierra Leone, Liberia, Ghana, Nepal, Mexico, Honduras, Tajikistan, Republic of Georgia, Saudi Arabia, Malawi and other countries in the context of international development, research, extension, education, and business.

RESEARCH SESSIONS — Saturday, October 20

SESSION 1 — 8:30-10 a.m.

Developing Land

Room 314 A, Illini Union

- Lazarus Adua and Linda Lobao
(University of Utah/Ohio State University)
Business Actors, Land Use Policies, and Development across the United States
- Daniel B. Ahlquist (Michigan State University)
Developing Nai Daeng: How Thai development policies promote unsustainability and foster insecurity in upland farming communities
- Ryan Stock (University of Illinois at Urbana-Champaign)
Illuminating the agrarian question in solar resource/states

Collective Action

Room 314 B, Illini Union

- Diana Mincyte, Aiste Bartkiene, and Renata Bikauskaite
(City University of New York/Vilnius University, Lithuania)
Let's Do It! World: Ecological Citizenship and the Politics of Development in Lithuania
- Silpa Satheesh (University of South Florida)
Resisting Development: Probing the connection between Environmental Movements and Development Burdens in the context of Kerala, India
- Luiz Vilaça (University of Notre Dame)
Dam-building, Development and Inclusion: the Role of Activist Bureaucrats in the Case of the Belo Monte Dam

Cash Transfers and Microcredit

Room 210, Illini Union

- Wahidah R. Bulan (UPM Veteran Jakarta, Indonesia)
Program Keluarga Harapan (Conditional Cash Transfers Program) and Poverty Reduction Efforts in Indonesia, Case Study in Bolmongel
- Cori Jane Hyde (Iowa State University)
Women's Empowerment in International Development: The use of microcredit programs

SESSION 2 — 10:30 a.m.-12 p.m.

Rural Development

Room 314 A, Illini Union

- Wanida Aaltonen (SOAS University of London, UK)
Creating Impactful Partnership through Shared Value: A Thai Jasmine Rice Business Case
- Elisabeth Garner (Pennsylvania State University)
Large-Scale Irrigation in Northern Ghana: A gender case study of success, cooperation, and exclusion
- David O'Brien and Eliot Meador (University of Missouri/Scotland's Rural College, UK)
Gender, Social Capital, and Commodity Effects on Overcoming Obstacles to Building Smallholder Federated Cooperatives
- Ieva Zumbyte (Brown University)
Persistence of Gender: Women's Empowerment, Wealth, and Community Norms in Rural India

Rights and Participation

Room 314 B, Illini Union

- Jennifer Keahey (Arizona State University)
We Have no Political Place to Stand on': Race and Democracy in Rural South Africa
- Jonathon Acosta, Juho Korhonen, and Keenan Wilder (Brown University)
Political Participation and Transformed Futures in Armenia, Bolivia, and Tunisia
- Vitor Martins Dias (Indiana University)
'I Came Here to Look for my Rights!' Social Problems, Legal Aid, and the Obstacles to Justice in the Urban Brazilian Amazon
- Matthias vom Hau (Barcelona Institut d'Estudis Internacionals (IBEI), Spain)
Implementing Multiculturalism: The Governance of Indigenous Land Claims in Argentina

Self-Sustaining Solutions?: Critical Reflections on Public Scholarship, Contested Development Spaces, and the Politics of Knowledge Production

Room 210, Illini Union

- Bobby Smith II (University of Illinois)
Building Emancipatory Food Power: Freedom Farms, Rocky Acres and the Struggle for Food Justice
- Delilah Griswold (Cornell University)
Democratizing Data: (In)different Technologies for Environmental Knowledge
- Kendra Kintzi (Cornell University)
Public Forests, Forest Publics: Environmental Imaginaries and the Politics of Sustainable Knowledge Production in the West Bank
- Aubryn Sidle (Cornell University)
Action on Agency: A Theoretical Framework for Defining and Operationalizing Agency in Girls' Education Practice

SESSION 3 — 1:30-3 p.m.

Rural Development 2

Room 314 A, Illini Union

- Yetkin Borlu (University of Richmond)
Credit Expansion, Financial Inclusion, and Exploitation: Credit Regulation in Turkish Agriculture since the Great Recession
- Christian Man
(Center for Strategic and International Studies (CSIS))
The Disciplined do the Underwriting: A Mixed Methods Analysis of Emergency Seed Programs in Ethiopia
- John Aloysius Zinda and Shrey Kapoor
(Cornell University)
Metabolic Fractures: How Household Livelihood Practices Differentiate Agricultural Input Use in Southwest China

State Capacity

Room 314 B, Illini Union

- Iim Halimatusa'diyah (Iowa State University)
State Capacity and Public Provision in a Socially Fragmented Nation: A Sub-National Analysis of Maternal Mortality Disparities in Indonesia
- Jawied Nawabi (City University of New York at Bronx Community College)
Whatever Happened to Land Reform as a Precondition for Sustainable Economic Development?
- Ryan Nehring (Cornell University)
Producing 'the Company': Cultural Politics and the Crisis of Brazil's Embrapa

Participatory research for food security among smallholder farming households in Africa and Latin America

Room 210, Illini Union

- Sidney Madsen, Noelle LaDue, and Rachel Bezner Kerr
(Cornell University)
Co-production of knowledge using semi-structured interviews: Experiences from collaboration with farmer researchers in a participatory agroecology project in Malawi
- Stephanie Enloe and Rachel Bezner Kerr
(Cornell University)
Managing the new kapuchi: Participatory research and farmer knowledge of agroecological pest management in northern Malawi
- Hanson Nyantakyi-Frimpong (University of Denver)
Imposing Seeds: A Feminist Political Ecology of NGO-funded Seed Banks and Smallholder Farmers? Resilience to Climate Change in Northern Ghana
- Ernesto Mendez (University of Vermont)
Participatory Action Research (PAR) processes in Agroecology with Coffee Smallholder Farmers in Mesoamerica: Reflections and Lessons

SESSION 4 — 3:30-5 p.m.

Economic Policy

Room 314 A, Illini Union

- Christian Eliott (Cornell University)
The ‘Social Infrastructure’ in Green Finance: Opportunities and Obstacles for Financing Sustainable Development in Middle Income Countries
- Nicholas Jepson (University of Manchester, UK)
A new bonanza? Structural power and policy heterodoxy under commodity boom conditions
- Roshan Pandian (Indiana University)
Explaining ‘Premature’ Deindustrialization
- Aaron Z. Pitluck (Illinois State University)
How to elude ‘speculation’ by tethering finance to the ‘real’ economy: Development theory from the case of Islamic Banking and Finance

Spatial Inequality and Development

Room 314 B, Illini Union

- Timothy Gorman (Montclair State University)
The Costs of Being Khmer: Spatial Determinants of Ethnic Minority Poverty in Vietnam
- Brian Thiede, Leif Jensen and David L. Brown (Pennsylvania State University/Cornell University)
Uneven Development and Income Inequality in Rural America, 1970-2015
- Thomas Andrew VanHeuvelen (University of Illinois)
The Core Model of Development and Subnational Inequality, 1939-2015

Digital Divide and Social Democratic Development

Room 210, Illini Union

- Aarushi Bhandari (State University of New York, Stony Brook)
Women’s Agency and the Gender Digital Divide: A Cross National Quantile Regression Analysis
- Samuel Cohn, Lexie Ford, and Bryson Bassett (Texas A&M)
Social Democratic Development—Creating Growth by Investing in Poor People: Supporting Evidence from Leontief Input Output Matrices
- Firuzeh Shokooh Valle (Franklin and Marshall College)
Dreams and Nightmares: Online Violence, Development, and the ‘Third World’ Technological Woman

RESEARCH SESSIONS — Sunday, October 21

SESSION 5 — 8:30-10 a.m.

Migration

Room 314 A, Illini Union

- Kathleen Ayako Anangwe (University of Nairobi, Kenya)
The Problem of Urbanizing Rural African Youth and its impact on Sustainable Food Security: An Analysis of the Realities and Intentions of Migrant Rural Youth
- Valeria Bonatti and Parthiban Muniandy (Bard College/Sarah Lawrence College)
Sustaining Sustainable Development: Invisible Labor of Migrant Workers in Neoliberal Green Economies
- Aaron Malone (University of Colorado, Boulder)
Diaspora Bureaucracy? Formalizing emigrant engagement and the evolution of Mexico's 3x1 Program

Health

Room 314 B, Illini Union

- Rita Jalali (American University)
Gender Inequality and Personal Hygiene in Resource Poor Countries: An Embodiment Perspective
- Shiri Noy (Denison University)
For the Children? An Analysis of the World Bank's Maternal and Infant Health Projects in Latin America
- Logan D. A. Williams (Michigan State University)
Development Aid or User Fees: Health Service Providers Pursuing Economic Sustainability in the Global South

Institutions

Room 210, Illini Union

- Tamo Chattopadhyay (American University of Central Asia, Kyrgyz Republic)
Capacity Development or Capacity Dependence? Interrogating a Persistent Development Obstacle in Central Asia
- Denise Fernandes and David Cipler (University of Colorado, Boulder)
The Post Paris World: Obstacles to development in an evolving world order
- Md Saidul Islam (Nanyang Technological University, Singapore)
Economic development without democracy: The China paradox
- Erin Metz McDonnell and Abigail Jorgensen (University of Notre Dame)
Do Political Institutions Improve Health?: A Cross-National Analysis of Democracy, State Health Spending, and Weberian Bureaucracy

SESSION 6 — 10:30 a.m.-12 p.m.

Migration and Labor

Room 314 A, Illini Union

- Ali R. Chaudhary (Rutgers University)
Organizational Constraints: How Ascriptive Stigma Hinders Pakistani Immigration Organizations from Fostering Development in Pakistan
- Amanda Flaim (Michigan State University)
Barriers to Justice and Development: Human Trafficking in the Thai Fishing Industry What Effects do Governance and Rule of Law Have on Female Labour Force Participation Rate in Africa?
- Katie Rainwater (Cornell University)
'Slave Labor' and Improving the lot of Wage Slaves? Modern-Day Slavery Allegations and Interventions in Thailand's Export-Driven Shrimp Industry

Gender, Culture, Supply Chains And Trade: Obstacles To Development—Or Facilitators?

Room 314 B, Illini Union

- Rae Lesser Blumberg (University of Virginia)
Gender, Trade And Development: Do Informal Traders Hurt or Help Development?
- Jennifer Bair (University of Virginia)
Labor Standards in Global Industries: The Case of Bangladesh
- Fauzia Ahmed (Miami University)
Feminist Governance as the Moral Economy of the Globalized Value Chain
- Gertrude Fraser (University of Virginia)
A Benefit or a Hindrance to Economic Well-Being? A Systematic Literature Review on sub-Saharan Women's Involvement in the Second-Hand Clothing Trade

Perspectives on International Engineering Projects

Room 210, Illini Union

- Ann-Perry Witmer (University of Illinois)
An ethnographic justification for the establishment of a Contextual Engineering discipline
- Keilin Jahnke (University of Illinois)
The ‘Good Intentions’ of Engineers: A study of the values that drive how practitioners approach international engineering projects
- Samantha Lindgren (University of Illinois)
The effectiveness of education and behavior change communication in cookstove adoption: a proposed research agenda
- Kelsey Schreiber (University of Illinois)
Beyond functionality: what matters to different stakeholders when evaluating project success in international engineering

I ILLINOIS

Sociology

COLLEGE OF LIBERAL ARTS & SCIENCES